

A1 INSTALLATION DRAWING

IF THIS DOCUMENT IS PRINTED IN HARDCOPY, IT IS FOR INFORMATION USE ONLY AND THEREFORE IS NOT SUBJECT TO UPDATING CONTROLS. ALWAYS REFER TO SOLIDWORKS VIEWER FOR LATEST ISSUE



THIS DRAWING IS CONFIDENTIAL AND IS SUPPLIED ON THE EXPRESS CONDITION THAT IT SHALL NOT BE LOANED OR COPIED OR DISCLOSED TO ANY OTHER PERSON OR USED FOR ANY OTHER PURPOSE WITHOUT THE WRITTEN CONSENT OF AP RACING LTD.



AP Racing
Wheler Road
Coventry
CV3 4LB

Tel: +44 (0) 24 7663 9595
Fax: +44 (0) 24 7663 9559
e-mail: engineering@apracings.com
Web site: <http://www.apracings.com>

© AP Racing Ltd. 2005

DISC PART NUMBERS:

CP3047-276 RH AS SHOWN
CP3047-277 LH OPPOSITE

THIS IS A 24 VANES DISC OF MASS 2.95Kg

SUFFIX TO DISC PART No's
P =PLAIN (NO GROOVES OR HOLES)
Gn =STRAIGHT GROOVES AS SHOWN, VALUE n PER FACE
i.e. G8 MEANS 8 GROOVES PER FACE.

THIS DISC WAS DESIGNED TO WORK WITH A D43 DEPTH PAD.

FOR DISC MOUNTING TECHNIQUES, BEDDING PROCEDURE AND DISC COOLING RECOMMENDATIONS SEE AP RACING BRAKE DISC CATALOGUE.

DISC INSTALLATION

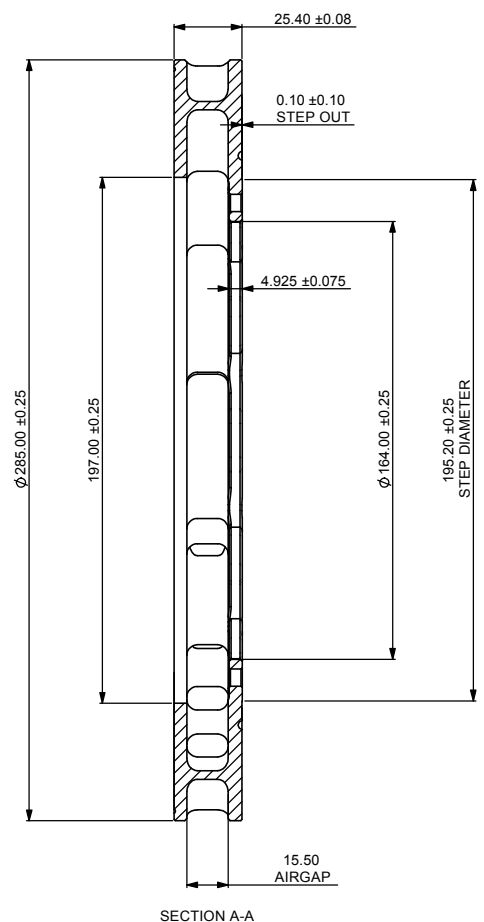
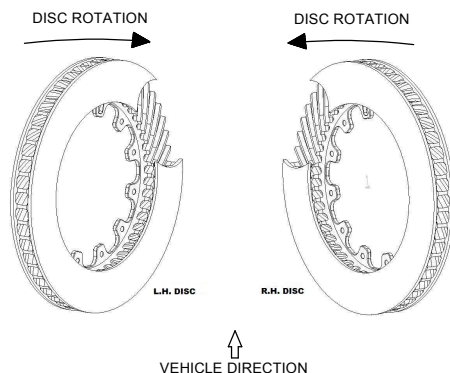

12 HOLES Ø6.425 ±0.025
EQUI-SPACED ON A 177.8 PCØ

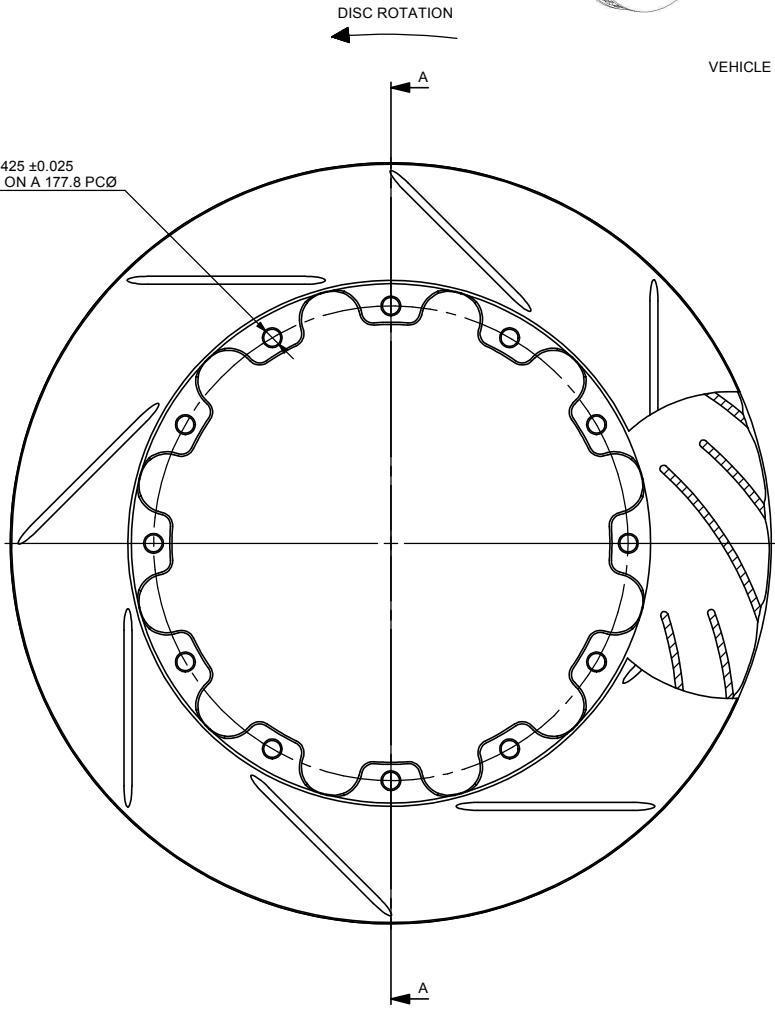

Issue No.	Alterations			Zone	Initials
	Date & No.	Particulars	#		
42	18/02/08	0.20 / 0.00 STEP OUT ADDED			
	34460:ID96	Ø195.2 ADDED. CUT OUTS MODIFIED			

SCALE 1:1		SHEET 1 OF 1	
DRAWN	D.ARROWSMITH		
APPROVED			
DERIVED FROM			
TITLE			
Ø285 x 25.4			
VENTILATED DISC			
DRG NO.	CP3047-276 / 277 CD		