

# A1 INSTALLATION DRAWING

IF THIS DOCUMENT IS PRINTED IN HARDCOPY, IT IS FOR INFORMATION USE ONLY AND THEREFORE IS NOT SUBJECT TO UPDATING CONTROLS. ALWAYS REFER TO SOLIDWORKS VIEWER FOR LATEST ISSUE



THIS DRAWING IS CONFIDENTIAL AND IS SUPPLIED ON THE EXPRESS CONDITION THAT IT SHALL NOT BE LOANED OR COPIED OR DISCLOSED TO ANY OTHER PERSON OR USED FOR ANY OTHER PURPOSE WITHOUT THE WRITTEN CONSENT OF AP RACING LTD.



AP Racing  
Wheler Road  
Coventry  
CV3 4LB

Tel: +44 (0) 24 7663 9595  
Fax: +44 (0) 24 7663 9559  
e-mail: [engineering@apracings.co.uk](mailto:engineering@apracings.co.uk)  
Web site: <http://www.apracings.com>

© AP Racing Ltd. 2005

CP3047-178 R.H AS DRAWN  
CP3047-179 L.H OPPOSITE  
  
THIS IS A 24 VANE DISC  
APPROX DISC WEIGHT = 4.24kg  
  
THIS DISC HAS BEEN DESIGNED TO WORK WITH A  
PAD SWEPT DEPTH OF D46

SUFFIX TO DISC PART NUMBERS:

SUFFIX	DETAILS
P	PLAIN (NO GROOVES)
Gn	STRAIGHT GROOVE - VALUE 'n' SPECIFIES NO. OF GROOVES PER FACE EG. G4 SPECIFIES 4 GROOVES PER FACE
CGn	CURVED GROOVE - VALUE 'n' SPECIFIES NO. OF GROOVES PER FACE EG. CG8 SPECIFIES 8 GROOVES PER FACE

FOR DISC MOUNTING TECHNIQUES, BEDDING PROCEDURE AND DISC COOLING RECOMMENDATIONS SEE A P RACING BRAKE CALIPER CATALOGUE

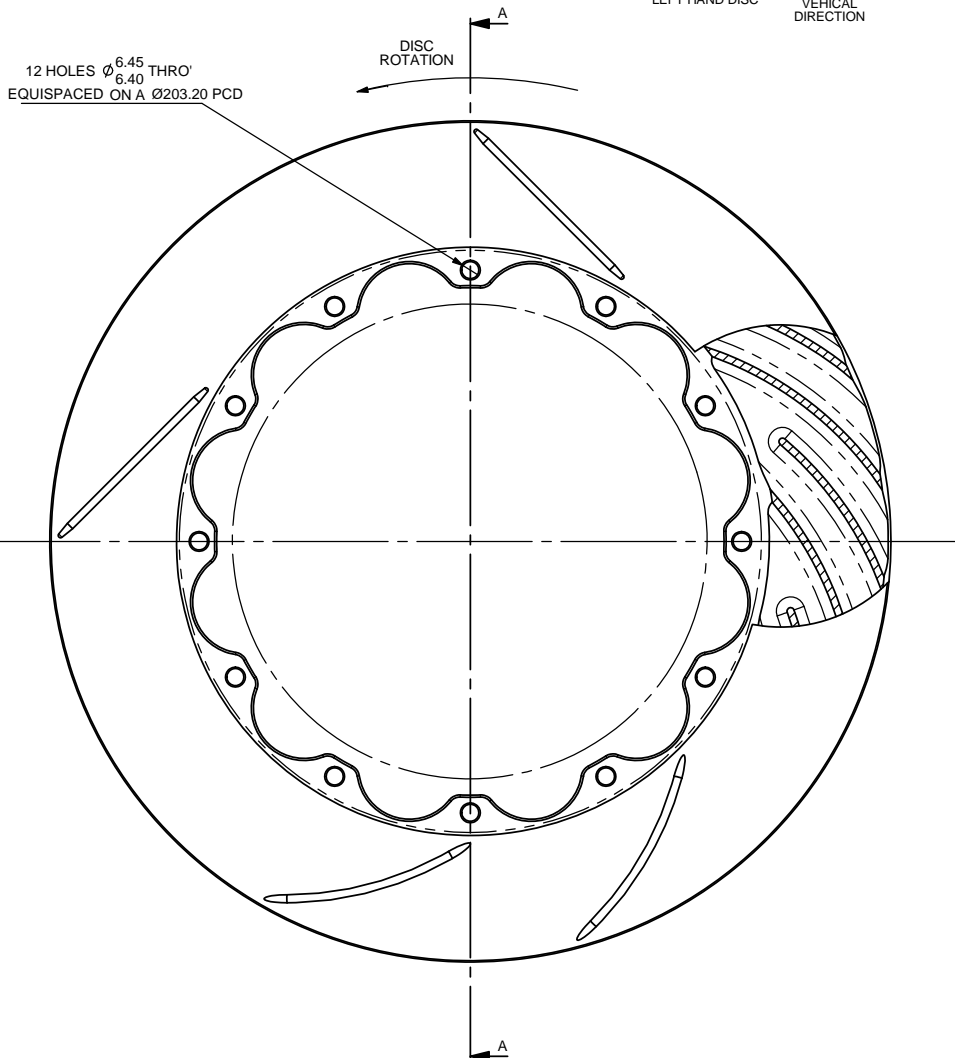
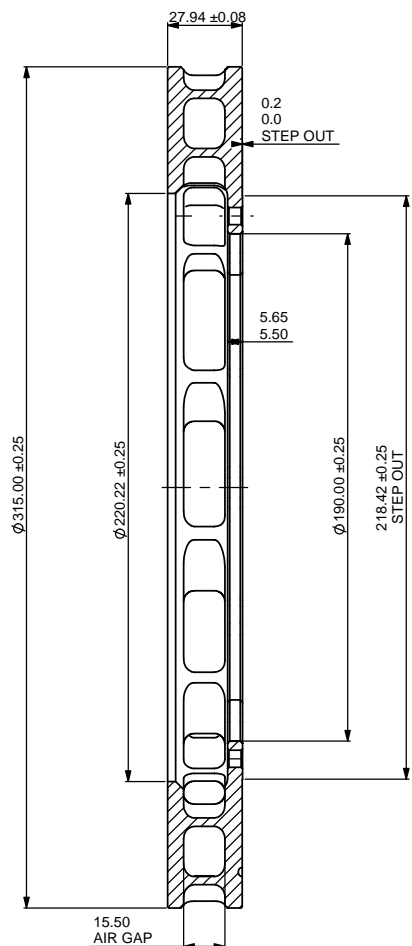
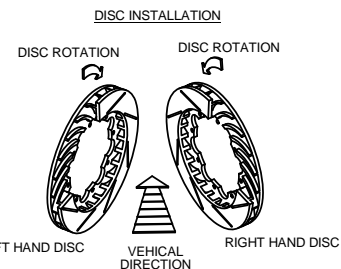

ISSUE No.	Alterations		Zone	Initials
	Date & No.	Particulars		
40	10/04/06 B4460	UPDATED WITH CURRENT GROOVE TYPES CONVERTED TO TWIN TURN 0.20/0.00 STEP ADDED Ø218.42 ADDED	4H 5E	SAT

SCALE 1:1	SHEET 1 OF 1
DRAWN	Steve Thomas
APPROVED	
DERIVED FROM	
TITLE	
Ø315.00 x 27.94	
VENTILATED DISC	
DRG NO.	CP3047-178/179